

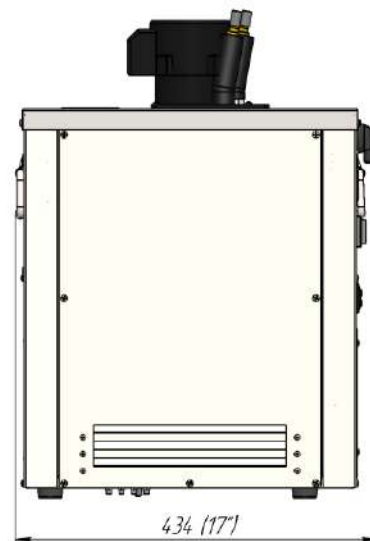

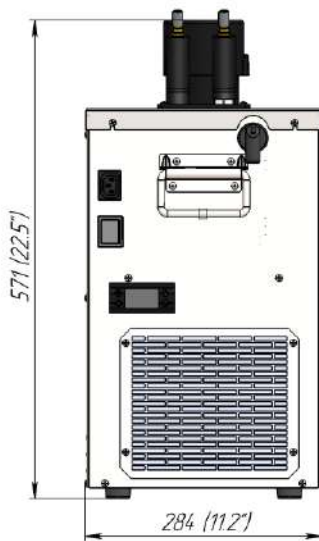

DIMENSIONS



SPECIFICATIONS

INTERNAL NUMBER	179.00.000.00-XX
PART NUMBER	CP1150V
MAXIMUM DISTANCE, FT	up to 25
CAPACITY, BTU/H	1150
GLYCOL TANK CAPACITY, GAL	2
COMPRESSOR POWER, HP	1/6
RUNNING, AMP	3.7
PLUG TYPE (NEMA #)	5-15P 
VOLTAGE, V	115
FREQUENCY, HZ	60
PUMP TYPE	Vertical
PUMP, GPH	185
NUMBER OF PRE-INSTALLED PUMPS	1
REFRIGERANT	R290
REFRIGERANT CHARGE, G (OZ)	75 (2.64) (Cubigel & Embraco compressors) 95 (3.35) (Secop compressor)
WEIGHT GROSS/NET, LBS	48/46
POWER CORD LENGTH, FT	6
INLET/OUTLET BARB, IN	3/8
OPERATING AMBIENT TEMPERATURE, °F	60-90
CLEARANCE AT LEAST	12" around the entire unit
GLYCOL MIXTURE, VOL%	40 % glycol and 60% water

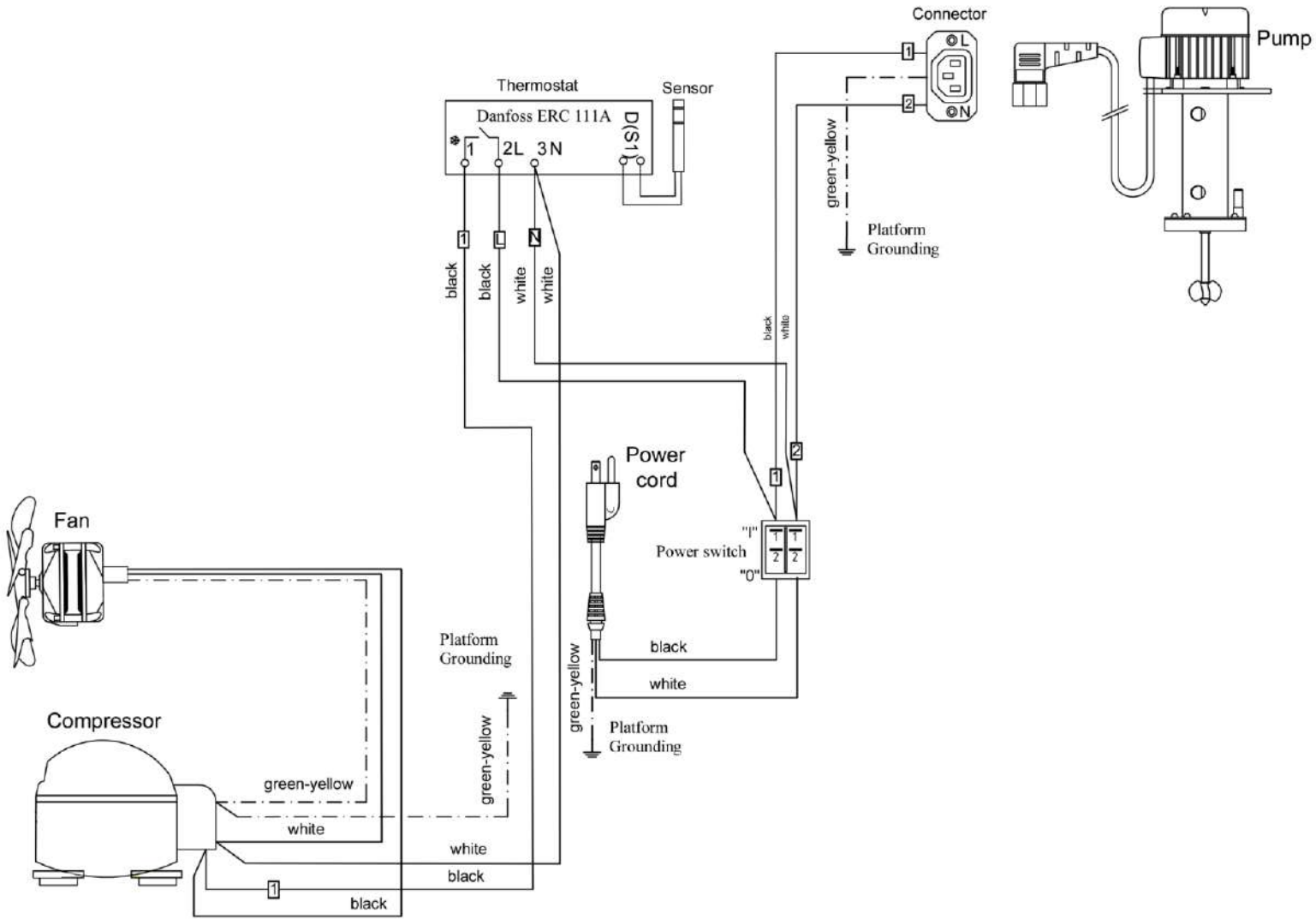

WIRING DIAGRAM

PARTS

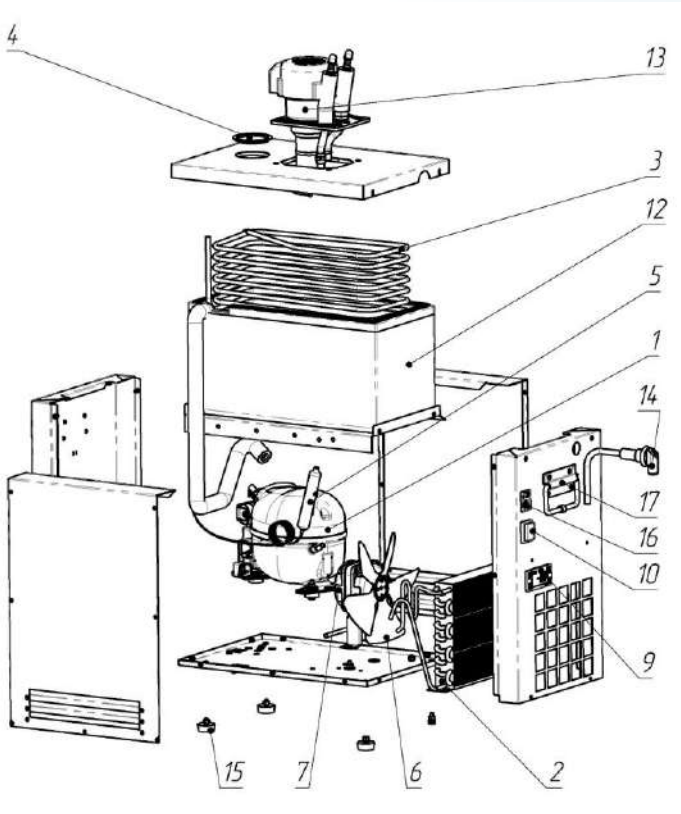

1	Compressor "EMBRACO" EMI 50UER (115-127 V/60Hz) or "CUBIGEL" NBC30NR (115V, 60Hz) or "SECOP" DLE4CN (115-127V/60Hz)
2	Air condenser "KARYER" STFT 12118
3	Evaporator
4	Cap
5	Filter-drier "DE-NA" GR-15 d6.1xd6.1xd2.1
6	Impeller "ELCO" $\varnothing 172$ mm., $\alpha = 28^\circ$
7	Electric motor "ELCO" NU 4-13-2 115 V, 60/50 Hz or "ELCO" NUI 5-13-2 115 V, 60/50 Hz
9	Thermostat "ELIWELL" EWPlus 961(115 V/ 60Hz) or "DANFOSS" ERC 111A (115V/ 60Hz)
10	Power switch "ARCOLECTRIC" C6053ALBR (Red)
12	Glycol bath
13	Glycol pump SPC 17/4, (115V/60Hz)
14	Overflow
15	Foot
16	Connector R302SN 250V 10A
17	Handle